

ENGINE INFORMATION

4.108

INDUSTRIAL 4 CYL, ROPE SEAL, SEMI FINISHED SLEEVE

BORE: 3.1250" 79.375mm



DESCRIPTION	PART NO.
O/H KIT, 4.108	A-OK410

For Models: (SKID STEER LOADER: 4600)

ENGINE COMPONENT PARTS

NOTICE: Parts included in the overhaul kits are indicated as follows:

M parts included in MAJOR OVERHAUL KITS

I parts included in IN FRAME OVERHAUL KITS

DESCRIPTION	PART NO.	SIZE	QTY	KIT
Piston Liner Kit	A-U5MK0118		4	M
Piston	A-69491		4	
Liner, Cylinder (Semi-Finished) 4.108 ¹	A-31358117		4	
Rings, Piston	A-41158008		4	



DESCRIPTION	PART NO.	SIZE	QTY	KIT
Bearing Set, Main	A-84992	STD	1	M
Bearing Set, Main	A-84992A	.010	1	M
Bearing Set, Main	A-84992B	.020	1	M
Bearing Set, Main	A-84992C	.030	1	M



DESCRIPTION	PART NO.	SIZE	QTY	KIT
Bearing Set, Conn Rod	A-85037	STD	1	M
Bearing Set, Conn Rod	A-85037A	.010	1	M
Bearing Set, Conn Rod	A-85037B	.020	1	M
Bearing Set, Conn Rod	A-85037C	.030	1	M



DESCRIPTION	PART NO.	SIZE	QTY	KIT
Washer Set, Thrust	A-0921120/118		1	M



DESCRIPTION	PART NO.	SIZE	QTY	KIT
Seal, Front Crankshaft	A-2415338		1	M



DESCRIPTION	PART NO.	SIZE	QTY	KIT
Valve Train Kit	A-VTK400		1	M
Valve, Intake	A-0910060		4	
Valve, Exhaust	A-0910061		4	
Guide, Intake Valve	A-3313E001		4	
Guide, Intake & Exhaust Valve	A-33261723		8	
Spring, Valve Inner	A-0780143		8	
Spring, Valve	A-0780144		8	
Seal, Valve	A-33817403		8	
Lock, Valve	A-0230001		8	



DESCRIPTION	PART NO.	SIZE	QTY	KIT
Bushing, Conn Rod	A-31134145		4	M
Bolt, Conn Rod	A-0095314		8	M
Connecting Rod	A-ZZ90005		4	



DESCRIPTION	PART NO.	SIZE	QTY	KIT
Gasket, Upper Set	A-742894M91		1	M
Gasket, Lower Set w/Seals	A-U5LB0013		1	M
Gasket, Head	A-36812134		1	



DESCRIPTION	PART NO.	SIZE	QTY	KIT
Camshaft	A-31415303		1	

DESCRIPTION	PART NO.	SIZE	QTY	KIT
Pump, Oil	A-41314092		1	
Pump, Fuel Lift Transfer	A-2641A058		1	



DESCRIPTION	PART NO.	SIZE	QTY	KIT
Assembly Lube; 8oz	A-10152		1	
Assembly Lube; Case of 12-8oz bottles	A-10153		1	



ALLIS CHALMERS

CASE-IH

CATERPILLAR

CLARK

DEUTZ

FIAT

FORD / NEW HOLLAND

GEHL

HYSTER

IMT

INGERSOLL RAND

JACOBSEN

JCB

JOHN DEERE

LANDINI

LEYLAND

LINCOLN ELECTRIC

MASSEY FERGUSON

MELROE

MICHIGAN

OWATTONA

PERKINS USA

RENAULT

SULAIR CORP

VERMEER

WHITE/OLIVER

ZETOR

Parts are not original equipment parts and are not sponsored, affiliated, or otherwise connected with any major brand.

1) Semi-Finished Sleeve

Parts are not original equipment parts and are not sponsored, affiliated, or otherwise connected with any major brand.

A-ZZ90160

Kit, Camshaft, 4.108

47.00 Lbs.

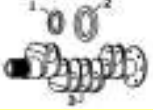

For Models: (SKID STEER LOADER: 4600)

Engine Related Parts



ALLIS
CHALMERS

CASE-IH

CATERPILLAR

CLARK

DEUTZ

FIAT

FORD / NEW
HOLLAND

GEHL

HYSTER

IMT

INGERSOLL
RAND

JACOBSEN

JCB

JOHN
DEERE

LANDINI

LEYLAND

LINCOLN
ELECTRIC

MASSEY
FERGUSON

MELROE

MICHIGAN

OWATTONA

PERKINS USA

RENAULT

SULAIR CORP

VERMEER

WHITE/
OLIVER

ZETOR